

Hermitage

The Hermitage was originally the home of Michael Hoy, a successful late eighteenth and early nineteenth century merchant trading mainly with Russia, and was originally built in 1813.

Hermitage barn has been beautifully converted with a large open plan living area featuring a large dining table, sleeping up to 10 people. This gives you the chance to share this holiday experience together and not miss a thing. The largest bedroom has a floor to ceiling glass screen which gives fabulous views over Niton village.

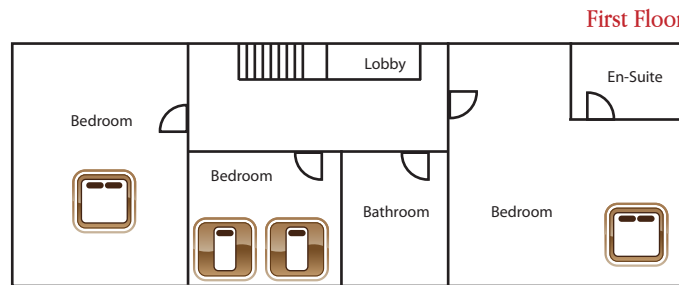
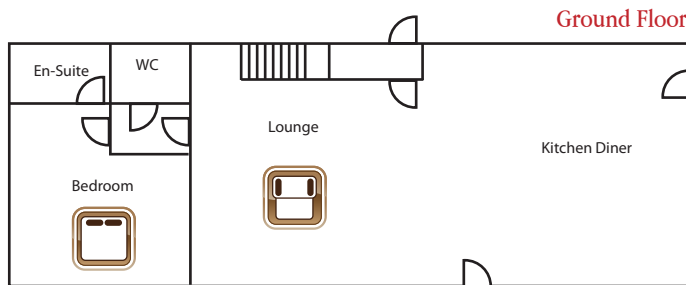

Updated: January 2010

	Week	Weekend	Midweek
Jan-04	710	555	455
Jan-08	710	555	455
Jan-15	710	555	455
Jan-22	710	555	455
Jan-29	710	555	455
Feb-05	710	555	455
Feb-12	810	640	530
Feb-19	710	555	455
Feb-26	710	555	455
Mar-05	710	555	455
Mar-12	710	555	455
Mar-19	710	555	455
Mar-26	710	555	455
Apr-02	810	640	530
Apr-09	810	640	530
Apr-16	710	555	455
Apr-23	710	555	455
Apr-30	810	640	530
May-07	710	555	455
May-14	710	555	455
May-21	710	555	455
May-28	810	640	530
Jun-04	920	690	560
Jun-11	920	690	560
Jun-18	920	690	560
Jun-25	920	690	560
Jul-02	920	690	560
Jul-09	920	690	560
Jul-16	1880	N/A	N/A
Jul-23	1880	N/A	N/A
Jul-30	1880	N/A	N/A
Aug-06	1880	N/A	N/A
Aug-13	1880	N/A	N/A
Aug-20	1880	N/A	N/A
Aug-27	1880	N/A	N/A
Sep-03	710	555	455
Sep-10	710	555	455
Sep-17	710	555	455
Sep-24	710	555	455
Oct-01	710	555	455
Oct-08	710	555	455
Oct-15	710	555	455
Oct-22	810	640	530
Oct-29	710	555	455
Nov-05	710	555	455
Nov-12	710	555	455
Nov-19	710	555	455
Nov-26	710	555	455
Dec-03	710	555	455
Dec-10	710	555	455
Dec-17	810	640	530
Dec-24	810	640	530